

СТУПЕНЧАТЫЙ ТОЛКАТЕЛЬ (ИСПОЛНЕНИЕ 1)

Through hardened shouldered ejector pins

Material: WS 1.2210
Standard: DIN1530-CH/ISO8694
Hardness: HRC58-62

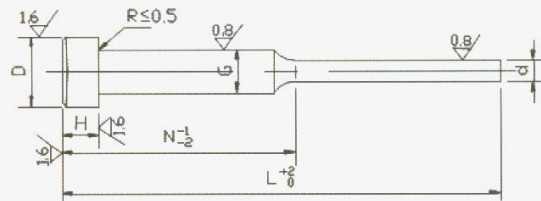

Code	d _(g6)	G ⁰ _{-0.1}	D ⁰ _{-0.2}	H ⁰ _{-0.05}	L/N					
					80/35	100/50	125/50	160/75	200/75	250/100
TZZD	0.8	2.0	4	2		*	*	*		
	0.9					*	*	*		
	1.0					*	*	*	*	
	1.1					*	*	*	*	
	1.2					*	*	*	*	
	1.3					*	*	*	*	
	1.4					*	*	*	*	
	1.5	3.0	6	3		*	*	*	*	*
	1.6					*	*	*	*	*
	1.7					*	*	*	*	*
	1.8					*	*	*	*	*
	1.9					*	*	*	*	*
	2.0					*	*	*	*	*
	2.1					*	*	*	*	*
	2.2					*	*	*	*	*
	2.3					*	*	*	*	*
	2.4					*	*	*	*	*
	2.5					*	*	*	*	*
	2.6					*	*	*	*	*
	2.7					*	*	*	*	*
2.8		*	*	*	*	*				
2.9		*	*	*	*	*				

Example: Order Catalog G×d×L—Q` ty(pcs)
TZZD 3×1×100—10(pcs)

СТУПЕНЧАТЫЙ ТОЛКАТЕЛЬ (ИСПОЛНЕНИЕ 2)

Material: WAS 1.2344

Standard: DIN1530-C/ISO8694

Nitrided shouldered ejector pins

Hardness: Surface: \geq HV950

Core : HRC40-45

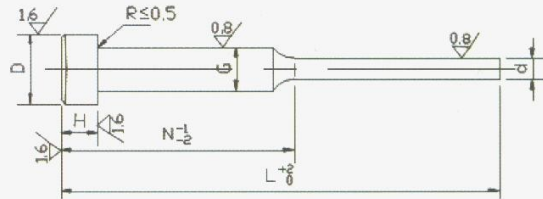

Code	d _(g6)	G _{-0.1} ⁰	D _{-0.2} ⁰	H _{-0.05} ⁰	L/N					
					80/35	100/50	125/50	160/75	200/75	250/100
TZSD	0.8	2.0	4	2		*	*	*		
	0.9				*	*	*			
	1.0				*	*	*	*		
	1.1				*	*	*	*		
	1.2				*	*	*	*		
	1.3				*	*	*	*		
	1.4	*	*	*	*					
	1.5	3.0	6	3	*	*	*	*	*	*
	1.6				*	*	*	*	*	*
	1.7				*	*	*	*	*	*
	1.8				*	*	*	*	*	*
	1.9				*	*	*	*	*	*
	2.0				*	*	*	*	*	*
	2.1				*	*	*	*	*	*
	2.2				*	*	*	*	*	*
	2.3				*	*	*	*	*	*
	2.4				*	*	*	*	*	*
	2.5				*	*	*	*	*	*
	2.6				*	*	*	*	*	*
2.7	*				*	*	*	*	*	
2.8	*	*	*	*	*	*				
2.9	*	*	*	*	*	*				

Example: Order Catalog G×d×L—Q` ty(pcs)
TZSD 3×1×100—10(pcs)

СТУПЕНЧАТЫЙ ТОЛКАТЕЛЬ (ИСПОЛНЕНИЕ 3)

Material: WAS 1.2344
Standard: DIN1530-C/ISO8694
Hardness: surface: Black Bath Nitrided to $\geq HV_{0.05} 950$ with MoS₂ coating
core: HRC40-45

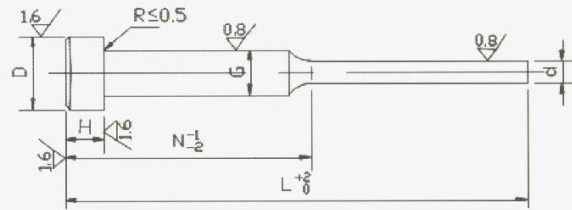

Code	d _(g6)	G _{-0.1} ⁰	D _{-0.2} ⁰	H _{-0.05} ⁰	L/N					
					80/35	100/50	125/50	160/75	200/75	250/100
DZSDB	0.8	2.0	4	2		*	*	*		
	0.9					*	*	*		
	1.0					*	*	*	*	
	1.1					*	*	*	*	
	1.2					*	*	*	*	
	1.3					*	*	*	*	
	1.4	3.0	6	3		*	*	*	*	
	1.5					*	*	*	*	*
	1.6					*	*	*	*	*
	1.7					*	*	*	*	*
	1.8					*	*	*	*	*
	1.9					*	*	*	*	*
	2.0					*	*	*	*	*
	2.1					*	*	*	*	*
	2.2					*	*	*	*	*
	2.3					*	*	*	*	*
	2.4					*	*	*	*	*
	2.5					*	*	*	*	*
2.6		*	*	*	*	*				
2.7		*	*	*	*	*				
2.8		*	*	*	*	*				
2.9		*	*	*	*	*				

Example: Order Catalog No G×d×L—Q` ty(pcs)
TZSDB 2×1×100—10(pcs)

СТУПЕНЧАТЫЙ ТОЛКАТЕЛЬ (ИСПОЛНЕНИЕ 4)

Standard: JIS

Shouldered ejector pins

Material	Hardness
SKD-61	Surface: HV _{0.3} ≥ 950 Core : HRC40-45
SUJ-2	HRC58-62

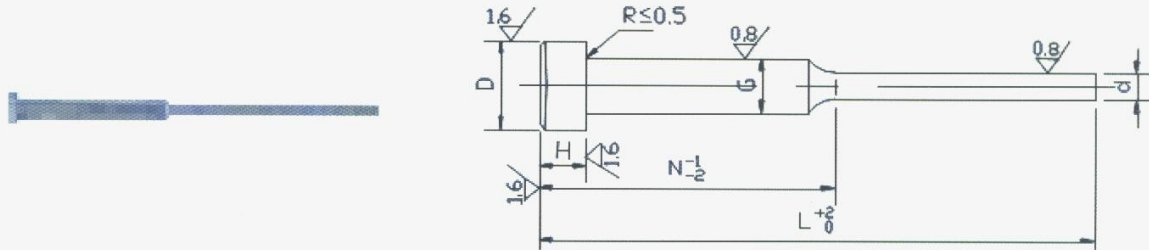

Code	d ^{-0.01} _{-0.02}	G ⁰ _{-0.1}	D ⁰ _{-0.2}	H ⁰ _{-0.05}	L/N				
					100/25,50	150/50,70	200/50,70	250/70,100	300/70,100
TZSC (TZSC)	0.8	3	6	4	*	*			
	1				*	*			
	1.2				*	*	*	*	
	1.5				*	*	*	*	*
	2				*	*	*	*	*
	2.5				*	*	*	*	*

Example: Order Catalog No G×d×L—Q¹ty(pcs)
SKD61:TZSC 3×1×100—10(pcs)
SUJ-2:TZSC 3×1×100—10(pcs)