

ТРУБЧАТЫЙ ТОЛКАТЕЛЬ (ИСПОЛНЕНИЕ 1)

Material: WS 1.2210
Standard: DIN16756/ISO8405
Hardness: HRC58-62

Ejector Sleeves - trough hardened

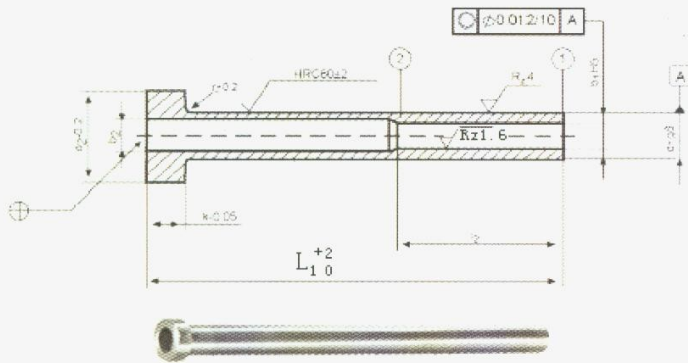

b1	g6	H5
0.5-3	-0.002 -0.008	+0.004 0
3.01-6	-0.004 -0.012	+0.005 0
6.01-10	-0.005 -0.014	+0.006 0
10.01-18	-0.006 -0.017	+0.008 0
18.01-30	-0.007 -0.020	+0.009 0
30.01-50	-0.009 -0.025	+0.013 0

Code	d1g6	b1H5	d2	k	b2	L2	L1+2/0														
							60	75	100	125	150	175	200	225	250	275	300				
STZD	3	1.5	6	3	1.8	25															
		1.6			2																
	4	2	8		2.4	35			*	*	*	*	*								
		2.2			2.5				*	*	*	*	*								
	5	2.5	10		3	45			*	*	*	*	*								
		2.7			3.5				*	*	*	*	*								
		3		4.0				*	*	*	*	*	*								
	6	3.2	12	5	4.5	50			*	*	*	*	*	*							
		3.5			5.5				*	*	*	*	*	*							
	8	4	14	7	6.5			*	*	*	*	*	*	*	*						
		4.2			8.5			*	*	*	*	*	*	*	*						
	10	5	16	7	10.5																
		5.2			12.5																
	12	6	20	7	10.5																
		6.2			12.5																
	14	8	22	7	10.5																
8.2		12.5																			
16	10	22	7	10.5																	
	10			12.5																	

Example: Order Catalog No b1×d1×L1—Q`ty(pcs)
STZD 1.5×3×100—10(pcs)

ТРУБЧАТЫЙ ТОЛКАТЕЛЬ (ИСПОЛНЕНИЕ 2)

Material: WAS 1.2344
Standard: DIN16756/ISO8405
Hardness: surface: $\geq HV_{0.3}950$
core: HRC40-45

Nitrided ejector sleeves

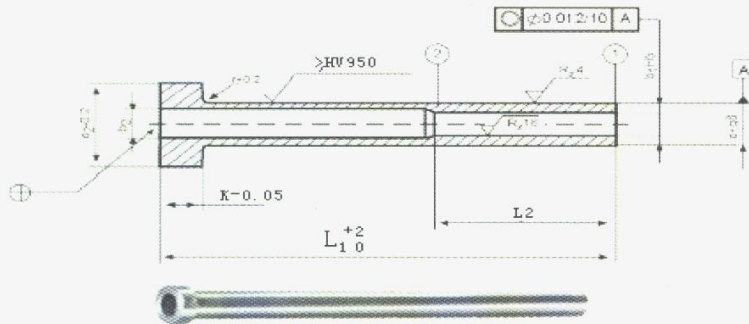

d1	g6	H5
0.5~3	-0.002 -0.008	+0.004 0
3.01~6	-0.004 -0.012	+0.005 0
6.01~10	-0.005 -0.014	+0.006 0
10.01~18	-0.006 -0.017	+0.008 0
18.01~30	-0.007 -0.020	+0.009 0
30.01~50	-0.009 -0.025	+0.013 0

Code	d1g6	b1H5	d2	k	b2	L2	L1 ⁺² ₀													
							60	75	100	125	150	175	200	225	250	275	300			
STSD	3	1.5	6	3	1.8	25														
		1.6			2															
	4	2	8		2.4	35			*	*	*	*	*							
		2.2			2.5				*	*	*	*	*							
	5	2.5	10		3	45			*	*	*	*	*							
		2.7			3.5				*	*	*	*	*							
		3		40				*	*	*	*	*								
	6	3.2	12	5	4.5	50			*	*	*	*	*	*						
		3.5			5.5				*	*	*	*	*							
	8	3.7	14	7	6.5															
		4			8.5			*	*	*	*	*	*	*						
	10	4.2	16	7	10.5															
		5			12.5			*	*	*	*	*	*	*	*					
	12	5.2	20	7	12.5															
		6																		
	14	6.2	22	7																
8																				
16	8.2																			
	10																			
16	12																			

Example: Order Catalog No b1×d1×L1—Q` ty(pcs)
STSD 2×4×100—10(pcs)

ТРУБЧАТЫЙ ТОЛКАТЕЛЬ (ИСПОЛНЕНИЕ 3)

Black MoS₂ Ejector sleeves

Material: WAS 1.2344
Standard: DIN16756/ISO8405
Hardness: surface: Black Bath Nitrided to $\geq HV_{0.3} 950$ with MoS₂ coating
core: HRC40-45

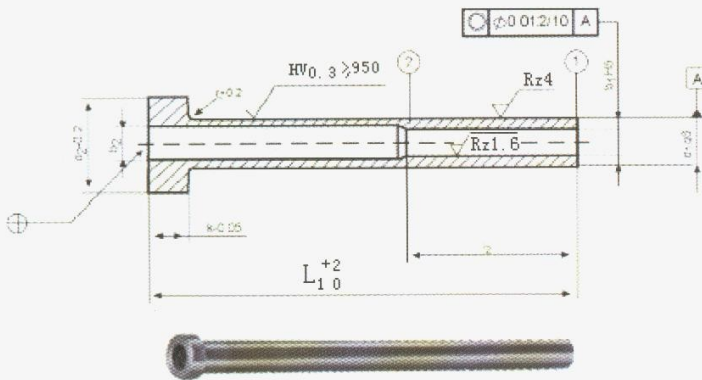

d1	g6	H5
0.5~3	-0.002 -0.008	+0.004 0
3.01~6	-0.004 -0.012	+0.005 0
6.01~10	-0.005 -0.014	+0.006 0
10.01~18	-0.006 -0.017	+0.008 0
18.01~30	-0.007 -0.020	+0.009 0
30.01~50	-0.009 -0.025	+0.013 0

Code	d1g6	b1H5	d2	k	b2	L ₂	L1 ⁺² / ₀													
							60	75	100	125	150	175	200	225	250	275	300			
STSDB	3	1.5	6	3	1.8	25														
		1.6			2															
	4	2	8		2.4															
		2.2			2.5	*	*	*	*	*										
	5	2.5	10		3	3														
		2.7				3.5	*	*	*	*	*									
	6	3	12	5	4.0	45														
		3.2																		
	8	3.5	14		4.5															
		3.7			5.5	*	*	*	*	*	*	*								
	10	4	16		6.5															
		4.2																		
	12	5	20	8.5																
		5.2																		
	14	6	22	10.5																
		6.2																		
16	8	22	12.5																	
	8.2																			

Example: Order Catalog No b1×d1×L1—Q⁺ty(pcs)
STSDB 2×4×100—10(pcs)

ТРУБЧАТЫЙ ТОЛКАТЕЛЬ (ИСПОЛНЕНИЕ 4)

Standard: JIS

Ejector Sleeves

Material	Hardness
SKD-61	Surface: HV _{0.3} ≥ 950 Core : HRC40-45
SUJ-2	HRC58-62

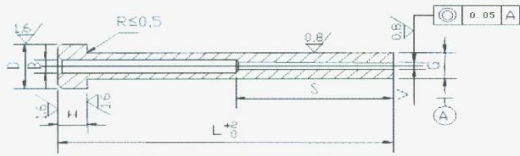

Code	G -0.01 -0.02	V +0.01 0	B +0.1 -0.1	D 0 -0.2	H 0 -0.05	S	L						
							100	125	150	175	200	250	300
STSC (STZC)	4	2.0	V+0.4	8	6	V<2.0 S=35-40	*	*	*				
							*	*	*				
	4.5	2.5		*			*	*					
				*			*	*					
	5	2.0		*			*	*	*	*			
				*			*	*	*	*			
	5.5	2.5		*			*	*	*	*			
				*			*	*	*	*			
	6	2		*			*	*	*	*	*	*	*
				*			*	*	*	*	*	*	*
	6	2.5		*			*	*	*	*	*	*	*
				*			*	*	*	*	*	*	*
	6	3		*		*	*	*	*	*	*	*	
				*		*	*	*	*	*	*	*	
	6	3.5		*		*	*	*	*	*	*	*	
				*		*	*	*	*	*	*	*	
	6	4		*		*	*	*	*	*	*	*	
				*		*	*	*	*	*	*	*	
	6	3.0		*		*	*	*	*	*	*	*	
				*		*	*	*	*	*	*	*	
	7	3.5		*		*	*	*	*	*	*	*	
				*		*	*	*	*	*	*	*	
	7	4.0		*		*	*	*	*	*	*	*	
				*		*	*	*	*	*	*	*	
7	3	*	*	*	*	*	*	*	*				
		*	*	*	*	*	*	*	*				
7	3.5	*	*	*	*	*	*	*	*				
		*	*	*	*	*	*	*	*				
8	4	*	*	*	*	*	*	*	*				
		*	*	*	*	*	*	*	*				
8	4.5	*	*	*	*	*	*	*	*				
		*	*	*	*	*	*	*	*				
8	5	*	*	*	*	*	*	*	*				
		*	*	*	*	*	*	*	*				
8	4	*	*	*	*	*	*	*	*				
		*	*	*	*	*	*	*	*				
8	4.5	*	*	*	*	*	*	*	*				
		*	*	*	*	*	*	*	*				
8	5	*	*	*	*	*	*	*	*				
		*	*	*	*	*	*	*	*				
9	4	*	*	*	*	*	*	*	*				
		*	*	*	*	*	*	*	*				
9	4.5	*	*	*	*	*	*	*	*				
		*	*	*	*	*	*	*	*				
9	5	*	*	*	*	*	*	*	*				
		*	*	*	*	*	*	*	*				
9	6	*	*	*	*	*	*	*	*				
		*	*	*	*	*	*	*	*				
9	6.5	*	*	*	*	*	*	*	*				
		*	*	*	*	*	*	*	*				
10	8	*	*	*	*	*	*	*	*				
		*	*	*	*	*	*	*	*				
10	8.5	*	*	*	*	*	*	*	*				
		*	*	*	*	*	*	*	*				
10	10	*	*	*	*	*	*	*	*				
		*	*	*	*	*	*	*	*				
10	12	*	*	*	*	*	*	*	*				
		*	*	*	*	*	*	*	*				
12	8	*	*	*	*	*	*	*	*				
		*	*	*	*	*	*	*	*				
12	8.5	*	*	*	*	*	*	*	*				
		*	*	*	*	*	*	*	*				
16	10	*	*	*	*	*	*	*	*				
		*	*	*	*	*	*	*	*				
16	12	*	*	*	*	*	*	*	*				
		*	*	*	*	*	*	*	*				

Example: Order Catalog No V×G×L—Q`ty (pcs)
SKD61: STSC 2×4×100—10 (pcs)
SUJ-2: STZC2×4×100—10 (pcs)